

TENTATIVE TIMELINE

FEBRUARY 8 - FEBRUARY 13

- LOUISE AVE WESTBOUND TRAFFIC WILL BE SHIFTED TO A SINGLE LANE AT THE NORTH SIDE
- THRU ACCESS TO REMAIN AT ALL TIME

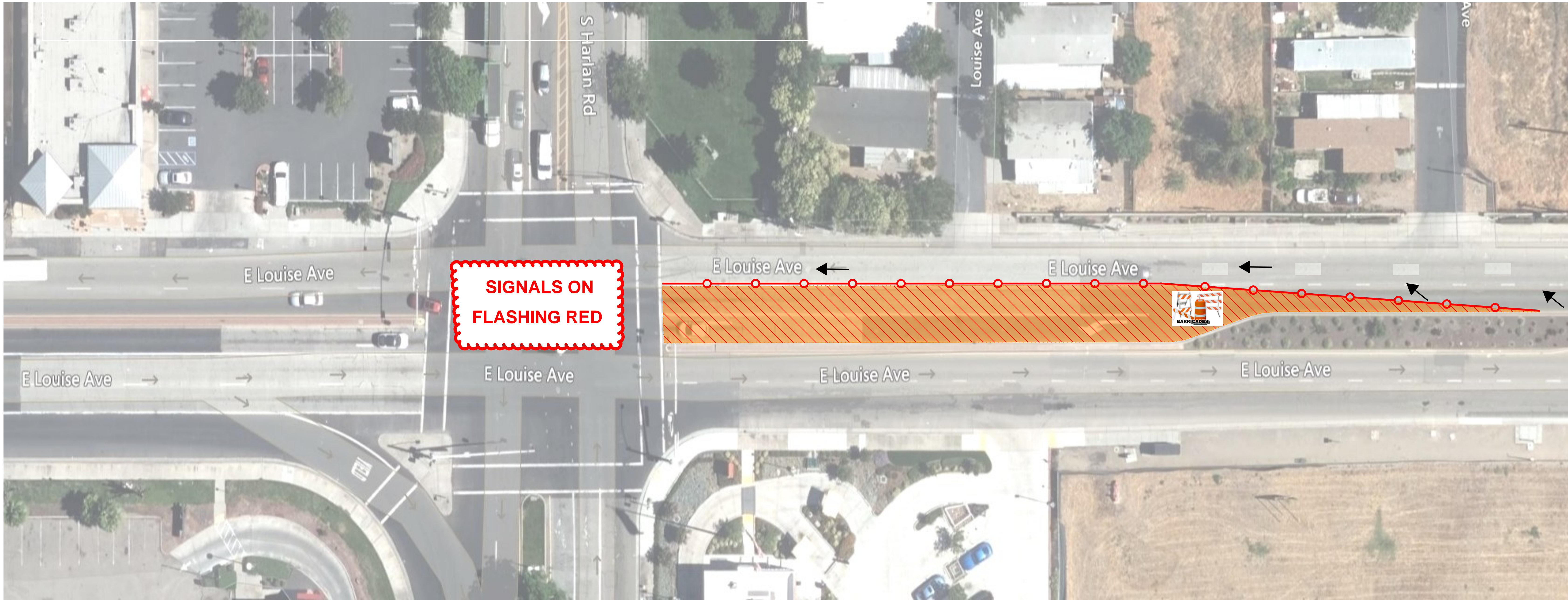
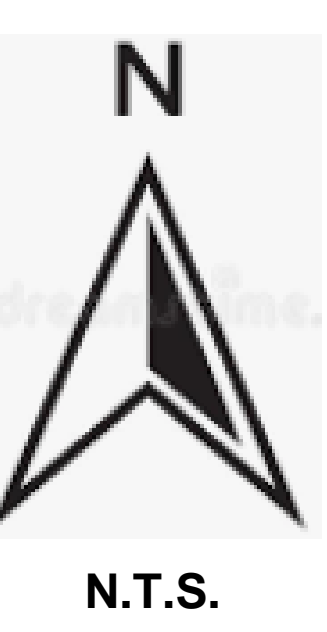

LEGEND

- Construction Zone



- Temporary Delineators



CIP PS 18-01 PROJECT - TEMPORARY CONSTRUCTION ON LOUISE AVENUE

WESTBOUND LIMITED THRU ACCESS